



GPI-20 TYPE PILOT FLAME BURNER

- **Function**

The pilot flame burner is used as of continuous operational ignition burner for various main burners which ignites the main burner

- starting of operation,
- with the help of its continuous operation providing nsafety service.

- **Field of application**

It can be applied for industrial burners and other type of heat recovery facilities, by the burners of furnaces and by forced air or injector type burners.

The primary field of application of this burner family is by tube furnaces of oil refineries.

- **Execution**

The members of the GPI type forced air pilot flame burner family is featured by forced air combustion air supply having same nominal heating capacity, but consisting of various built-in length of components.

- **Design features**

Its ignition is provided either by mobile ignitor, or with the help of ignition cartridge. Additional special advantage is, it allows direct assembling with the UV flame scanner too.

- **Chief technical data**

<i>Fuel:</i>	natural gas, fuel gas	<i>Flame length:</i>	max. 400 mm
<i>Heating value of gas:</i>	34 - 42 MJ/m ³ _n	<i>Nominal gas prssure:</i>	1 bar (controlled) *
<i>Nominal gas consumption</i>	2 m ³ _n /h	<i>Volume of combustion air:</i>	max. 15 m ³ _n /h
<i>Nominal heating value:</i>	20 kW	<i>Combustion air temperature:</i>	max. 40 °C
<i>Built-in length (L):</i>	80-1400 mm **	<i>Nominal air pressure:</i>	20 mbar (above the pressure of combustion chamber)

* standard gas pressure 1 bar, gas pressures are optional: 0,5 bar, 0,1standard

** length can be chosen in stages of 20 mm (by ordering)

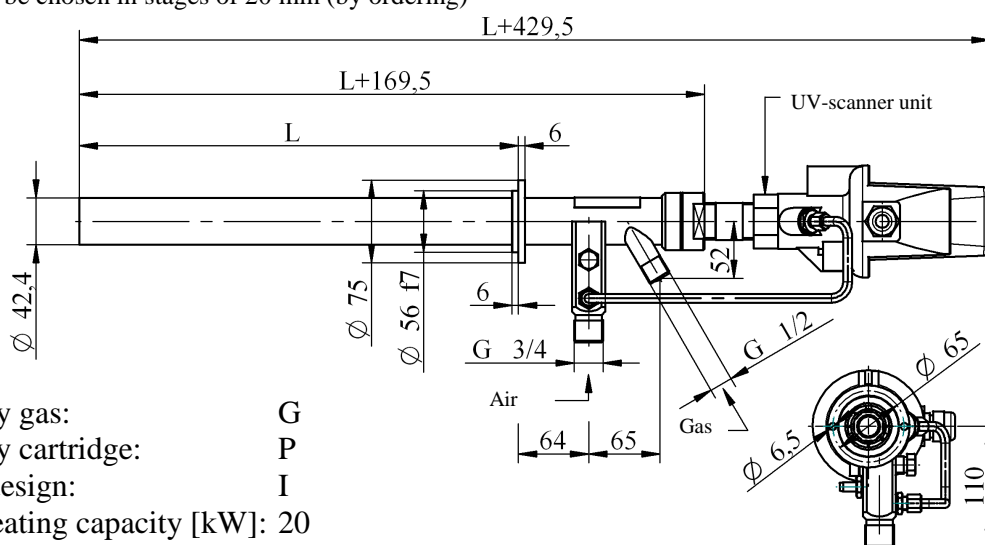

- **Types**

Operated by gas: G
Operated by cartridge: P
Industrial design: I
Nominal heating capacity [kW]: 20



TÜKI Research and Development Company for Combustion Technology

3515 Miskolc-Egyetemváros Pf. 3
Phone: (36/46) 555-070, Fax: (36/46) 555-078

